

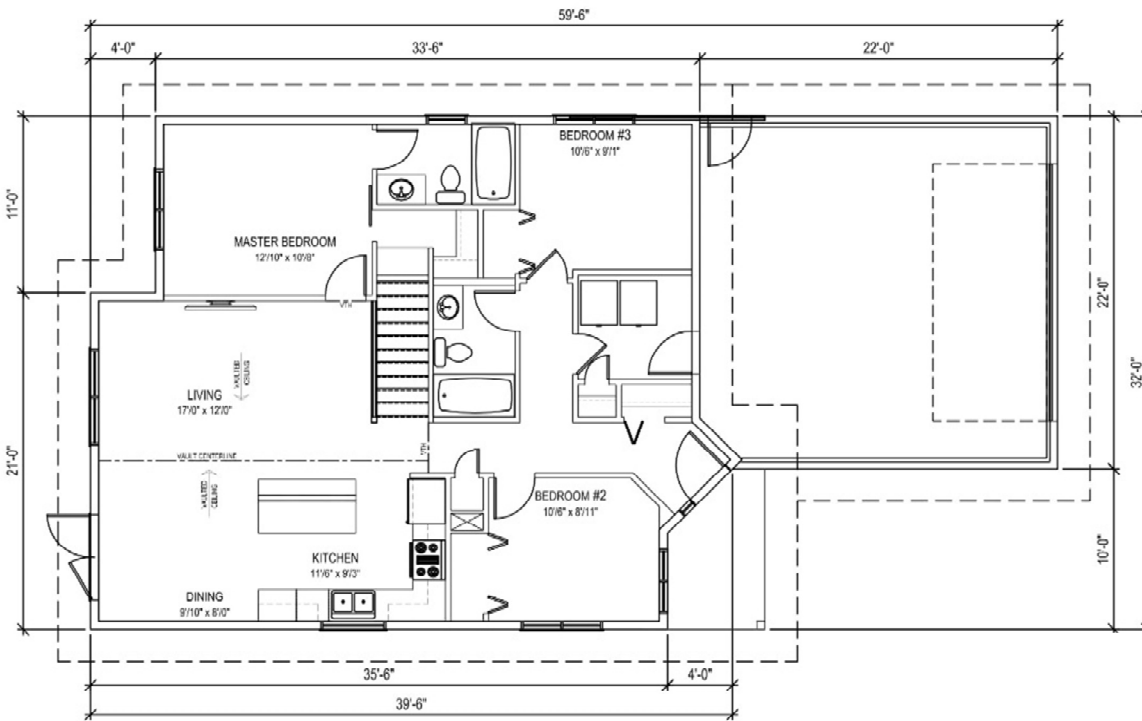

**3 Bedrooms | 2 Bathrooms | 1149 sq.ft.**  
Large living room | Vaulted Ceilings | Ensuite Bathroom

**SPALDING**  
39'6"X32'X33'6"  
1149 sq.ft.  
\$139,038.03



Actual plans may not be exactly as shown, and can be modified to suit your needs

**Western Canada's Most Trusted RTM Home Builder Since 1969**

J&H Homes, 2505 Ave C North, Saskatoon, SK S7L 6A6; [www.jhhomes.com](http://www.jhhomes.com); Phone- 306-652-5322



# SPALDING PLAN | 39'6"X32'X33'6" | 1149 SQ.FT.

6-Dec-18

## J&H BUILDER'S WAREHOUSE, SASKATOON, SK - STANDARD R.T.M. HOME SPECIFICATIONS

FINISH MATERIAL  
SHELVING & RODS  
LIGHT FIXTURES INSTALLED  
PAINTING - 1 Primer & 2 Finish coats  
COMPLETE PLUMBING - Main Bath & Ensuite  
MIRRORS  
BATH ACCESSORIES  
WASHER PLUMBING & DRYER OUTLET  
TAPING & TEXTURING CEILING  
CABINETS & COUNTERTOPS – Superior Millwork  
FLOOR COVERINGS  
WINDOWS - Triple Pane  
2 TV OUTLETS  
2 TELEPHONE OUTLETS  
1 CENTRAL VAC OUTLET  
EAVESTROUGHING

### HOME OPTIONS INCLUDED IN PRICING

LAUNDRY CABINETS  
TILE ABOVE KITCHEN COUNTERTOP  
DECORATIVE FRONT DOOR INSERT  
DBL GARDEN DOOR OFF DINING  
WOOD RAILING AT STAIRWELL  
UPGRADE TO TILED WALL SHOWER - in ensuite  
10' X 6' COVERED VERANDA ON FRONT

TOTAL \$139,038.03

\*GARAGE NOT INCLUDED\*

PRICES ARE SUBJECT TO CHANGE WITHOUT NOTICE, TAXES NOT INCLUDED.

LIKE THIS PLAN BUT WANT TO CHANGE IT TO FIT YOU? WE CAN DO THAT!

