

ROCKFORD | 1493 sq.ft.



The **ROCKFORD** | 48'X40' | 1493 sq.ft. | 3 Bedrooms | 2 Bathrooms

YOUR PLAN OR OURS

Not exactly what you're looking for?
All plans are fully customizable.

*May be shown with optional features, including, but not limited to material and colours. Overall dimensions shown, excluding verandas.



Western Canada's Most Trusted RTM Home Builder Since 1969

J&H Homes | 2505 Avenue C North, Saskatoon, SK | S7L 6A6 | www.jhhomes.com | 306.652.5322 | info@jhhomes.com

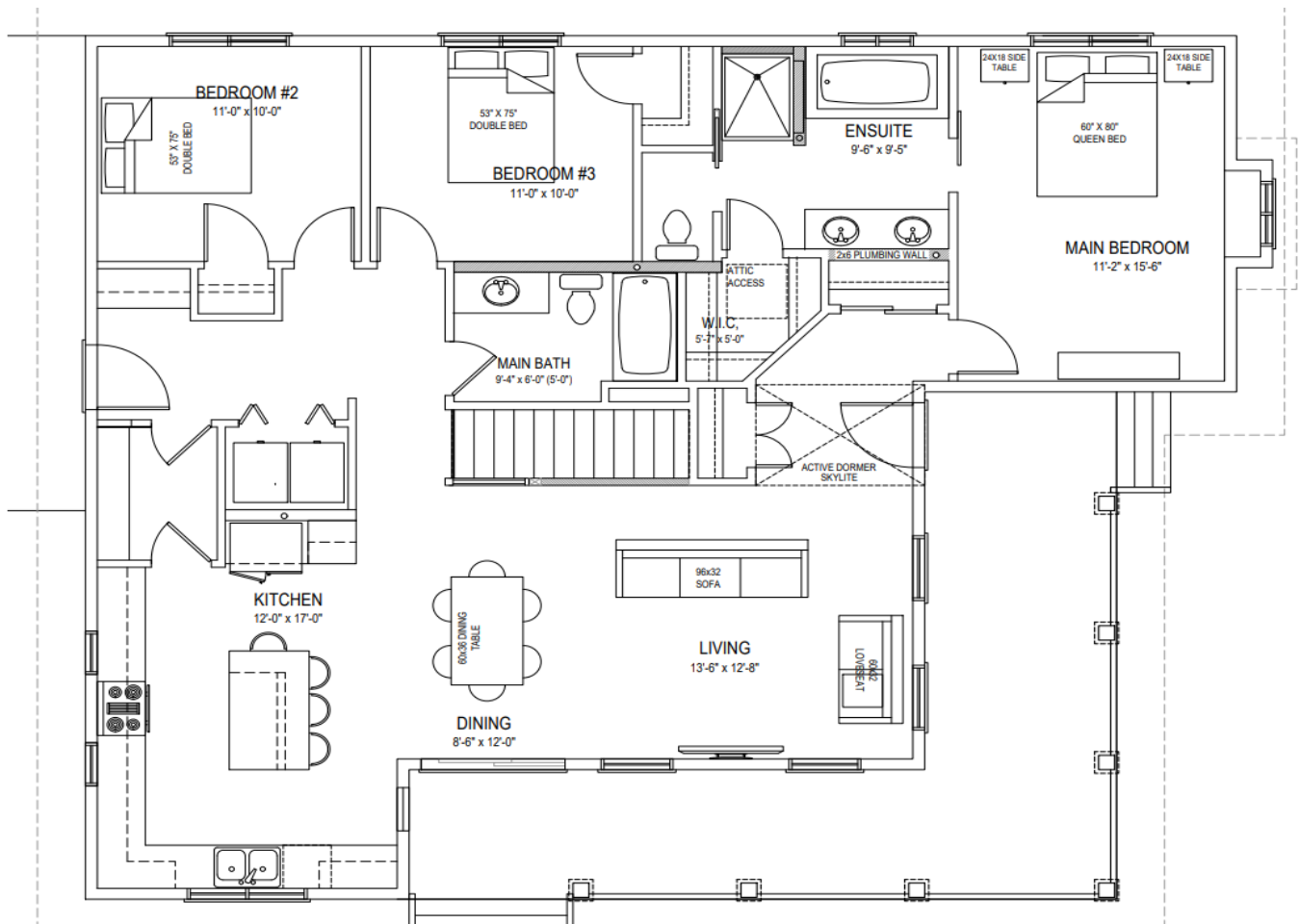

The ROCKFORD

A Private Retreat

WELCOME HOME to The Rockford. This unique 1493 sq.ft. plan is for the family who values sanctuary, with private space for each member of the family.

- Open-plan and lots of natural light make this home feel spacious.
- A totally separate luxury master suite will make you feel you have the whole house to yourself.
- Storage is no longer a problem with large closets & a game-changing walk-through pantry.
- Watch the sun rise on your wrap-around deck.



Western Canada's Most Trusted RTM Home Builder Since 1969

J&H Homes | 2505 Avenue C North, Saskatoon, SK | S7L 6A6 | www.jhhomes.com | 306.652.5322 | info@jhhomes.com