



The Radville II - 1621 Sq. Ft.



HIGHLIGHTS

- Mudroom
- Open concept
- Deck off dining room
- Jetted tub

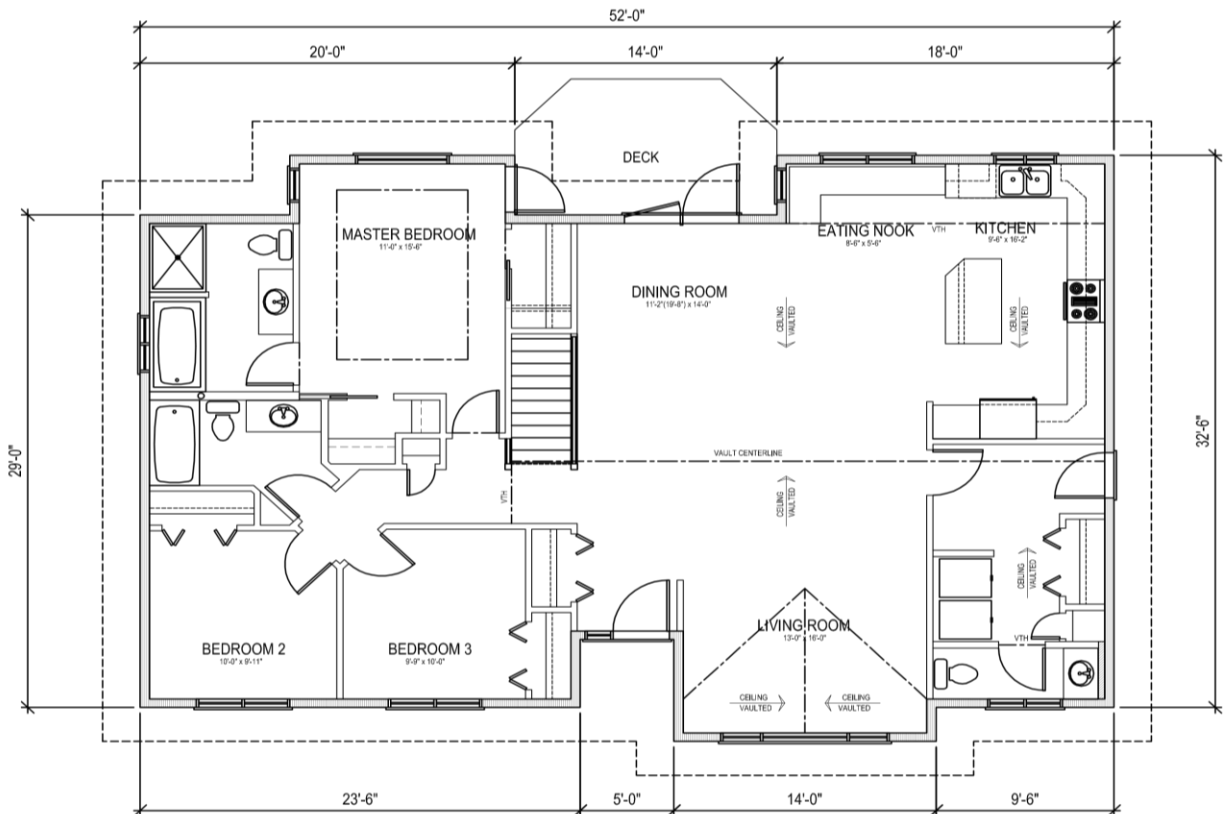

2505 Ave C N
Saskatoon, Sask
(306) 652-5322
www.jhhomes.com

J&H Homes...Western Canada's Most Trusted RTM Home Builder Since 1969

Actual plans may not be exactly as shown, and can be modified to suit your needs.

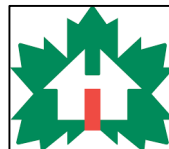

March 9, 2017

RADVILLE II PLAN - 34'-6" X 29' X 52'
1621 SQ. FT.

J&H BUILDERS WAREHOUSE, SASKATOON, SK - STANDARD R.T.M. HOME SPECIFICATIONS

FINISH MATERIAL
SHELVING & RODS
LIGHT FIXTURES INSTALLED - includes 30 pot lights
PAINTING - 1 Primer and 2 Finish Coats
COMPLETE PLUMBING
MIRRORS
BATH ACCESSORIES
WASHER PLUMBING & DRYER OUTLET
TAPING & TEXTURING CEILING
CABINETS & COUNTERTOPS – Superior Millwork
FLOOR COVERINGS
UPGRADE WINDOWS – Triple Pane HS2A
2 TV OUTLETS
2 TELEPHONE OUTLETS
2 CENTRAL VAC OUTLETS
EAVESTROUGHING

HOME OPTIONS INCLUDED IN PRICING

WINDOW SEATS FOR EATING NOOK
DECK OFF DINING ROOM
TILE ABOVE KITCHEN COUNTERTOP
48" X 36" TILED WALL SHOWER IN ENSUITE
JETTED TUB IN ENSUITE
COFFERED CEILING IN MASTER
KITCHEN ISLAND
9' CEILING THROUGH OUT
MATCHING INSERTS ON ENTRY FRONT DOOR c/w sidelite
COTTAGE ROOF
DOUBLE GARDEN DOOR OFF DINING ROOM
SINGLE GARDEN DOOR OFF MASTER BR
BAY PROJECTIONS (2)
WOOD RAILING AT STAIRWELL
ROCK ON LR WALL (126 LN FT)
ENLARGE FRONT WINDOW

TOTAL

\$ 218,501.46

GARAGE NOT INCLUDED

PRICES ARE SUBJECT TO CHANGE WITHOUT NOTICE TAXES NOT INCLUDED