



The Radville I - 1616 Sq. Ft.



HIGHLIGHTS

- Great traditional farm design
- Main floor laundry
- Optional front veranda

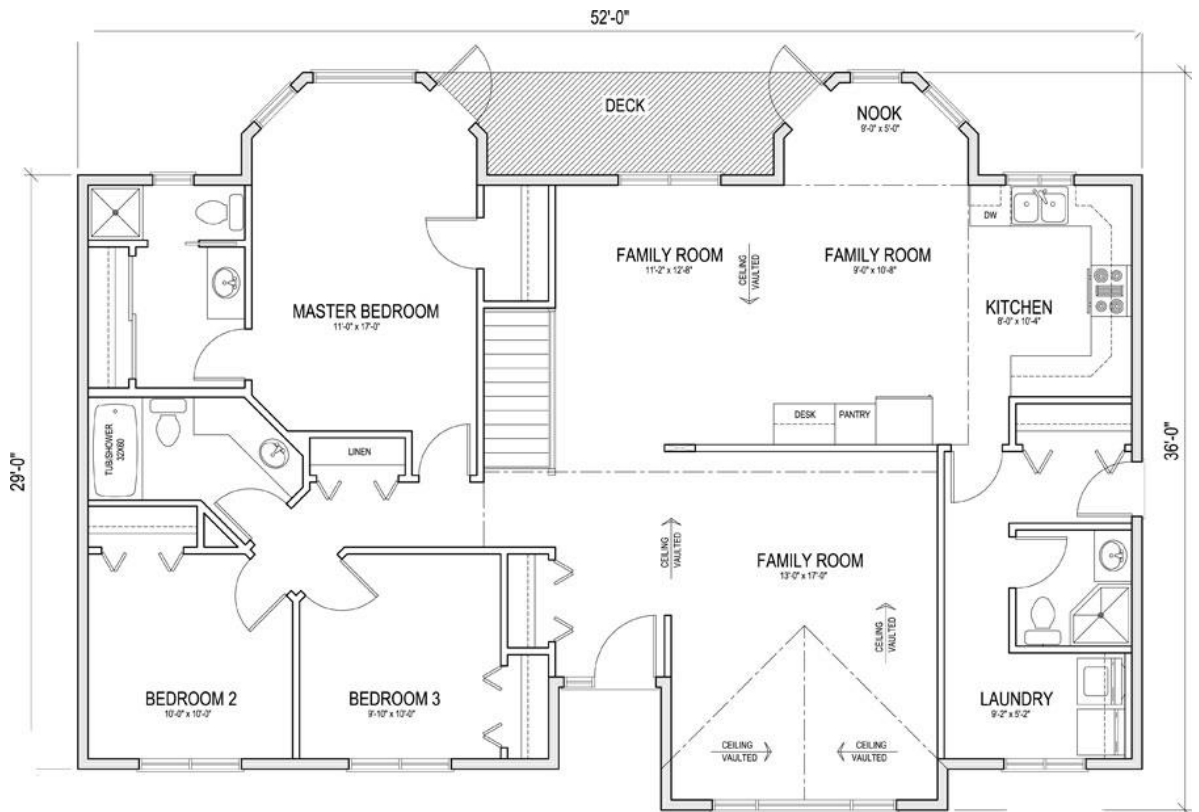

2505 Ave C N
Saskatoon, Sask
(306) 652-5322
www.jhhomes.com

J&H Homes...Western Canada's Most Trusted RTM Home Builder Since 1969

Actual plans may not be exactly as shown, and can be modified to suit your needs.



March 9, 2017

RADVILLE I -PLAN - 36' X 29' X 52'
1616 SQ. FT.

J&H BUILDERS WAREHOUSE, SASKATOON, SK - STANDARD R.T.M. HOME SPECIFICATIONS

FINISH MATERIAL
SHELVING & RODS
LIGHT FIXTURES INSTALLED - includes 6 kitchen pot lights, 4 in living room
PAINTING - 1 Primer and 2 Finish Coats
COMPLETE PLUMBING
MIRRORS
BATH ACCESSORIES
WASHER PLUMBING & DRYER OUTLET
TAPING & TEXTURING CEILING
CABINETS & COUNTERTOPS – Superior Millwork
FLOOR COVERINGS
UPGRADE WINDOWS – Triple Pane HS2A
2 TV OUTLETS
2 TELEPHONE OUTLETS
2 CENTRAL VAC OUTLETS
EAVESTROUGHING

HOME OPTIONS INCLUDED IN PRICING

UPPER CABINETS - UTILITY ROOM
TILE ABOVE KITCHEN COUNTERTOP
JETTED TUB IN MAIN BATH
VAULTED CEILING, LI, DI, KI
INSERT ON FRONT DOOR WITH MATCHING SIDELITE
WINDOW GRILLS ON FRONT
SINGLE GARDEN DOORS (2)
BAY PROJECTIONS (2)
WOOD RAILING AT STAIRWELL
ENLARGE FRONT WINDOW

TOTAL

\$ 190,267.32

GARAGE NOT INCLUDED

PRICES ARE SUBJECT TO CHANGE WITHOUT NOTICE, TAXES NOT INCLUDED